



# CAMPUS ÖREBRO NOVA HOUSE

Design Juul Frost Architects ([www.juulfrost.dk](http://www.juulfrost.dk))

Location Örebro, Sweden

Built Area 9,500m<sup>2</sup>

Photographs Felix Gerlach

Editor Kim Eun-ji

설계 율 프로스트 아키텍츠

위치 스웨덴 외레브로

면적 9,500m<sup>2</sup>

사진 펠릭스 게를라흐

에디터 김은지





Seating lounge of entrance



Atrium

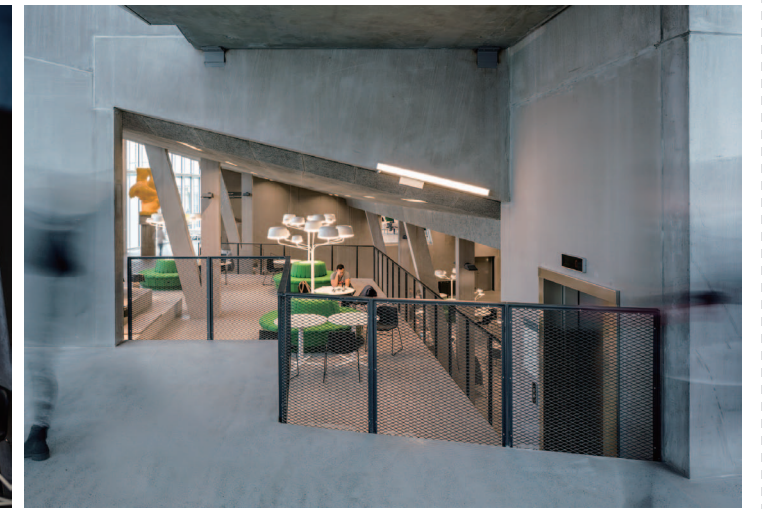

- 1. Entrance
- 2. Seating lounge
- 3. Atrium
- 4. Research area
- 5. Meeting area
- 6. Auditorium



2nd Floor plan

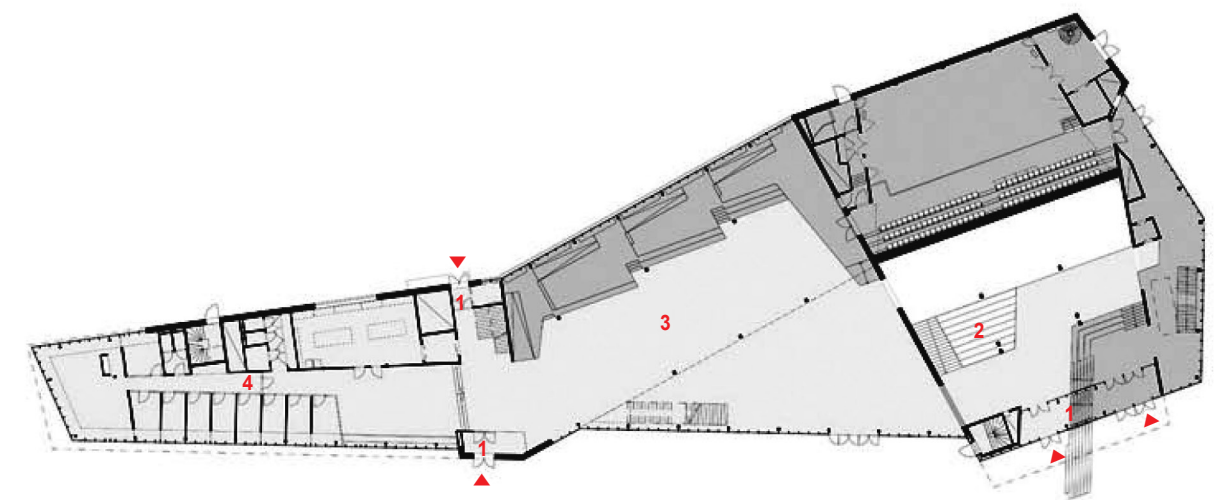

1st Floor plan



Stairs





Corridor of research room



Auditorium



Meeting room

Today the term campus is evolving. Campus development is both complex and dynamic and should be done with an eye on the future. The massive dependency on a shared set of values between the campus and town, value forming physical organisation as well as awareness of the social and human aspects that form the campus identity. That identity can never be fixed and is as the city: transformative and rejuvenating - always on its way. Örebro is going through an exciting development as a knowledge city with the transformation of the expansive university campus. The Nova house, with its 560 seat auditorium, is an educational, exchange and meeting place connecting the university, business life and the city. The building, with its large glass facades, opens out to the university square - the new central arrival point - and hereby underlines the principle idea, that openness and visibility support a modern and innovative study environment. In the evenings the translucent facade glows and invites students and the city's citizens into the main atrium and auditorium - the buildings soaring focal point. Beyond the campus square and the business college, 100 new student and researcher apartments as well as the business center, Alfred Nobel Science Park, form part of the project and contribute to the creation of a dynamic urban life around the entrance zone.

Helle Juul, Founding Partner, Architect MAA/MNAL, Ph.D.; "The way to a successful campus goes through our tools for the optimising of multifunc-

tional, open and transparent spaces, which support varied teaching, gatherings and working processes. It concerns thus both/and. That the same spaces should fulfil many functions at different times of the day, should be freely available, support different types of learning, gathering, and working processes. By supporting multi functional processes, new situations and possibilities of use occur, a greater utilisation and occupancy of which they should support" new ways of learning - new ways of working".

요즘 캠퍼스에는 강의뿐만 아니라 회의나 작업 등에도 사용할 수 있는 다기능의 공간이 요구된다. 이러한 추세를 반영하여 스웨덴 외레브로 시의 대학 캠퍼스 광장에 '노바 하우스'가 새롭게 문을 열었다.

먼저, 외관은 유리로 마감하여 개방감을 더했는데, 저녁이 되면 주변으로 빛을 반사하여 가시성을 높이고 있다. 내부 공간은 중앙 아트리움을 비롯하여 560석의 강당과 연구실, 회의 구역 등을 갖추고 있다. 전체적으로 심플한 마감 아래 초록, 빨강, 노랑색의 가구들로 포인트를 주어 멋진 공간에 활기를 더하고 있으며, 특히 아트리움에는 다양한 형태의 좌석을 마련해 휴식 및 회의 등의 용도에 따라 원하는 좌석을 선택해 사용할 수 있게 했다. 이외에도 위층에는 연구실과 함께 부스 형태의 실이 곳곳에 배치되어 개인적인 작업에 집중할 수 있다.

이곳은 다양한 기능을 보완하여 캠퍼스와 도시가 상생하는 혁신적인 미래형 캠퍼스를 제시하고 있다.